



# Extended Wear Male External Catheter

## Continence Care Tips\*

### General Information

The male external catheter, self-adhering and engineered with latex material, is available in standard length with 4 size ranges – each with a unique inner flap and application collar. External catheters provide men with a good alternative to indwelling catheters, diapers, or other absorbent products.

Four sizes are available, and the packaging is color-coded for easy identification.

- 22 mm – 25 mm
- 26 mm – 30 mm
- 31 mm – 35 mm
- 36 mm – 39 mm

### Selecting the Proper Size

- Use the color-coded Hollister sizing guide to determine the correct size needed
- Place the Hollister sizing guide beneath the largest area of the penis shaft (not the glans)

### Tips for Use

- Wash, rinse, and thoroughly dry the penis. Do not use lotions, powders, or emollients on the skin. Trim hair as needed
- Be sure to have good visualization and access to the area
- Place your thumb and forefinger in the finger cuts on the application collar and pinch the catheter closed (*Fig. 1 and 2*)
- Position the external catheter on the penis so that the inner flap touches the glans, taking care not to position the entire glans through the inner flap. Then, unroll the catheter onto the penis in a drawing motion toward the base
- **Do not force the plastic collar onto the penis.** Remove and discard the application collar after the catheter is in place (*Fig. 3*)
- Gently squeeze to ensure good contact between the adhesive and the skin. Pinch up an excess latex material for a custom fit all along the shaft. Do not attempt to reposition the catheter once it is placed. (*Fig. 4*)
- Connect to a bedside collector or a leg bag
- Secure the tubing leading to either a leg bag or gravity drainage bag to the individual's thigh to prevent unnecessary tugging on the catheter
- Position the tubing for the leg bag or gravity drainage bag below the level of the bladder

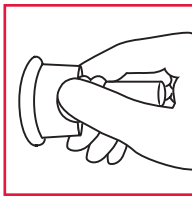

(Fig. 1)

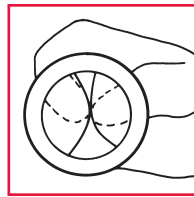

(Fig. 2)

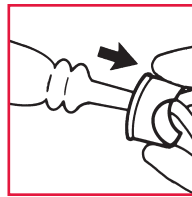

(Fig. 3)

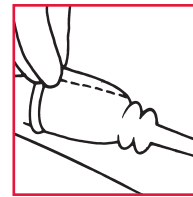

(Fig. 4)

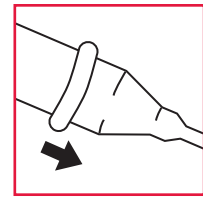

(Fig. 5) see reverse

**CAUTION:** This product contains natural rubber latex which may cause an allergic reaction. Do not use on irritated or compromised skin. Do not use if allergic reaction occurs. Prior to using the Extended Wear Male External Catheter, be sure to read the entire product Instructions for Use that accompany the product.

# Extended Wear Male External Catheter

## Continence Care Tips

---

### Frequently Asked Questions

---

**Q: *How long do these catheters stay on?***

**A:** A variety of factors such as application technique, individual anatomy and condition of the skin may influence wear time. With proper application, you can expect up to 24 hours of wear time.

**Q: *Is sizing important in selecting the right external catheter?***

**A:** Yes. The Hollister sizing guide is available to help in proper catheter size selection. If the patient is between sizes, select the larger of the two sizes, apply the catheter, and crimp the excess latex material on the shaft so the urine does not channel beneath the catheter and cause leakage.

**Q: *How should I clean the bedside collector or leg bag used with an external catheter?***

**A:** There are several commercially available products to clean urine collection devices. The Hollister m9 cleaner/decrystallizer is one such product. The m9 cleaner/decrystallizer is odorless, pH balanced, and comes with its own mixing bottle with a tapered tip to fit inside most tubing. A bleach solution is not recommended.

**Q: *What is the best way to remove the external catheter?* (Fig. 5)**

**A:** Gently roll the catheter off the skin. A warm, wet washcloth, held over the catheter for approximately 30 seconds may help weaken the adhesive for easier removal in some cases. Adhesive remover wipes may also be helpful.

**Q: *Can a protective barrier wipe (such as Hollister skin gel protective dressing wipes) be used on the skin?***

**A:** Not initially recommended, but the barrier may be helpful if the skin is fragile.

**Q: *Can external catheters be used on an uncircumcised penis?***

**A:** Yes. Apply the catheter with the foreskin in its natural position.