



# NON36710RH Troubleshooting Guide

## Product Description

Product	Material Number	Description	Features
	NON36710RH	Medication Lock Box	<ul style="list-style-type: none"><li>- Lock box has a programmable thumbwheel combination lock for increased security</li><li>- Removable compartments and shelf piece allow for flexibility with organizing medicine bottles and pills</li><li>- Designed with ergonomic handle for carrying ease when traveling</li></ul>

## Troubleshooting Topics

### Top Issue # 1 – Unable to set combination lock

1. Remove the red tab from the combination wheel
2. Push the button to the right and the latch and box will open, see **Figure 1**.



**Figure 1.** Push the button to the right to open the latch and the box.

3. With the box lid open, push the button left towards the number wheels and hold (**Figure 2A**), while you set the number wheels to the desired combination (**Figure 2B**).

**NOTE:** DO NOT FORGET THE COMBINATION ONCE SET.

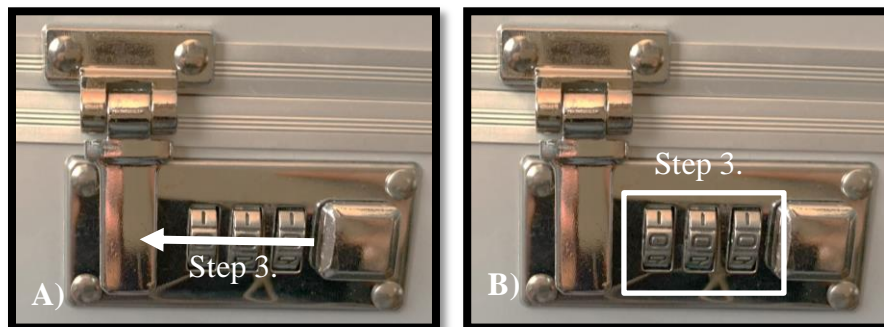

**Figure 2.** A) Push the button to the left towards and the number wheels and hold. B) Set the desired combination.



# NON36710RH Troubleshooting Guide

4. Release button. Your combination has now been set.

## Top Issue # 2 – Unable to open

1. Turn the number wheels until your combination is displayed in the center (**Figure 3**). Ensure that the number wheel is lined up exactly in the center.

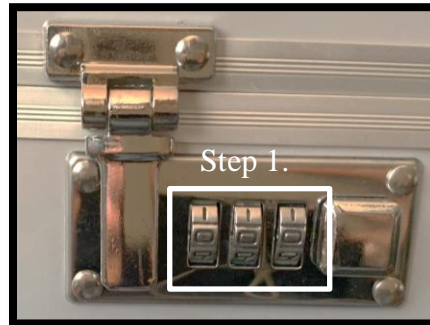

**Figure 3.** Turn the number wheels until your combination is displayed in the center.

2. Push the button to the right and the latch will open (**Figure 4**).



**Figure 4.** Push the button to the right to open the latch and box.