

The acapella® product family. Giving patients a breadth of fresh air.



VIBRATORY PEP THERAPY SYSTEMS

PORTEX™

Greater product breadth to better treat your patients.

The acapella® vibratory positive expiratory pressure (PEP) products are especially helpful in achieving the following therapeutic goals of bronchial hygiene therapy:

- Aiding in mobilization of retained secretions (in cystic fibrosis and chronic bronchitis patients)¹
- Preventing or reversing atelectasis¹
- Reducing air trapping in patients with asthma and COPD¹
- Optimizing delivery of bronchodilators in patients receiving bronchial hygiene therapy¹

acapella® products offer unique and convenient features that allow time savings for therapists and patients alike. Your patients won't be the only ones breathing easier!



| Key Features and Benefits | acapella® duet | acapella® choice | acapella® DH | acapella® DM |
|--|----------------|------------------|--------------|--------------|
| Functional in any position – Trendelenberg, standing, or sitting | • | • | • | • |
| Adjustable frequency and flow resistance settings | • | • | • | • |
| Treatment can be performed in less than half the time of a conventional CPT session ² | • | • | • | • |
| Distal 22mm O.D. fitting allows nebulizer connection via tee adapter | | • | • | • |
| Convenient built-in nebulizer port | • | | | |
| Streamlined body design offers easy grip | • | | | |
| Tethered cap helps reduce risk of contamination when in resting position | • | | | |
| Easily disassembled for heat disinfection via boiling, autoclaving, or placing in the dishwasher (top rack only) | • | • | | |
| ≥ 10 L/min expiratory flow requirement | • | • | | |
| ≥ 15 L/min expiratory flow requirement | | | • | |
| < 15 L/min expiratory flow requirement | | | | • |

acapella® product family features

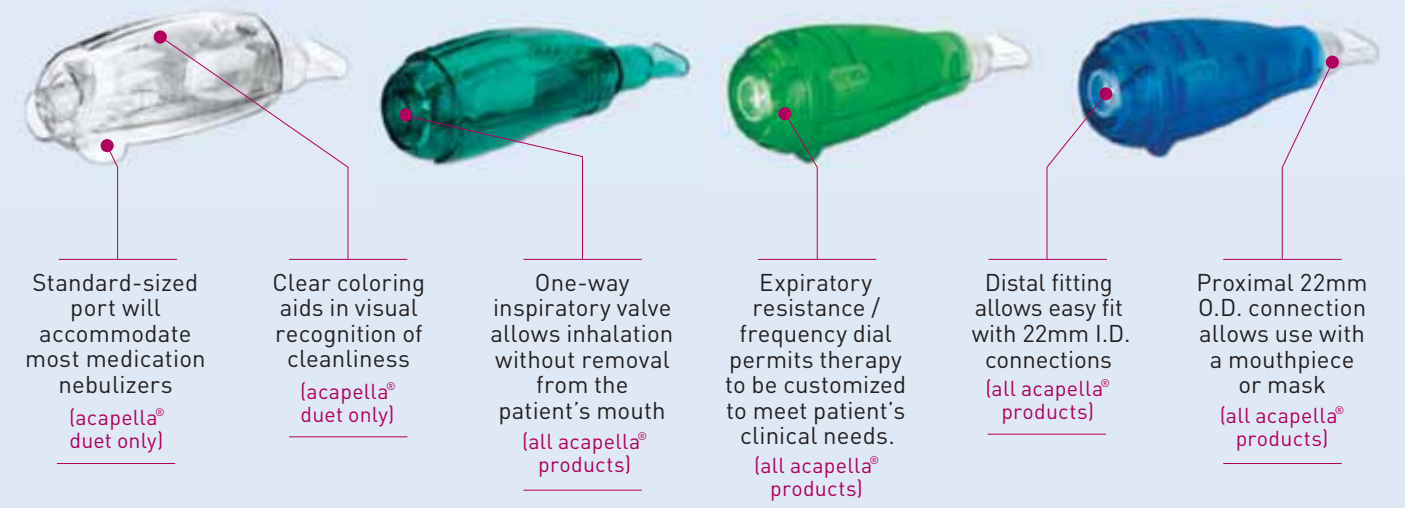

¹AARC Clinical Practice Guidelines, Use of Positive Airway Pressure Adjuncts to Bronchial Hygiene Therapy, published in Respiratory Care 1993;38(5):516-521.
²Mahlmeister MJ et al. "Positive-expiratory-pressure mask therapy: Theoretical and Practical Considerations and a Review of the Literature," Respiratory Care, 1991.

The acapella® vibratory PEP product family



acapella® duet



acapella® choice



acapella® DH



acapella® DM

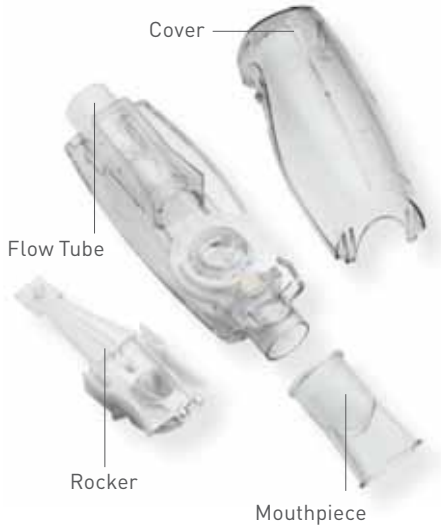

acapella® duet and acapella® choice vibratory PEP products are easily disassembled and reassembled for effortless cleaning.

For more information about the acapella® family of products, call us at (800) 258-5361 or visit us at www.smiths-medical.com.

| PART # | PRODUCT DESCRIPTION | UNITS/CASE |
|---|--|------------|
| acapella® duet vibratory PEP products | | |
| 27-9000 | acapella® duet kit, includes acapella® duet, mouthpiece, Portex® SVN, oxygen tubing, collapsible flex tubing | 10 |
| 27-9001 | acapella® duet and mouthpiece only | 10 |
| 007760 | Portex® updraft medication nebulizer | 50 |
| acapella® choice vibratory PEP products | | |
| 27-7000 | acapella® choice with mouthpiece | 10 |
| 27-7777 | acapella® choice with VHS Video | 5 |
| acapella® DH (green) vibratory PEP products | | |
| 21-1530 | acapella® DH with mouthpiece | 10 |
| 21-2530 | acapella® DH with VHS video | 5 |
| 21-3530 | acapella® DH with pediatric mask | 1 |
| 21-5530 | acapella® DH with medium mask | 1 |
| 21-7530 | acapella® DH with large mask | 1 |
| acapella® DM (blue) vibratory PEP products | | |
| 21-1015 | acapella® DM with mouthpiece | 10 |
| 21-2015 | acapella® DM with VHS video | 5 |
| 21-3015 | acapella® DM with pediatric mask | 1 |
| 21-5015 | acapella® DM with medium mask | 1 |
| 21-7015 | acapella® DM with large mask | 1 |
| acapella® accessories | | |
| 20-0022 | TheraPEP® pressure indicator, tubing & pressure port | 10 |
| 27-0050 | Replacement mouthpiece; fits all acapella® family designs | 50 |
| Instructional DVDs and VHS videos available in English and Spanish. Contact your local sales representative for more information. | | |

Note: Product is for single patient use only.

THE DETAILS GIVEN IN THIS LEAFLET ARE CORRECT AT THE TIME OF GOING TO PRESS. THE COMPANY RESERVES THE RIGHT TO IMPROVE THE EQUIPMENT SHOWN.

Smiths Medical ASD, Inc.

2331 Rutherford Road, Carlsbad, CA 92008 USA

Tel: (800) 848-1757 Fax: (800) 621-2590

www.smiths-medical.com

Smiths Medical, part of the global technology business Smiths Group.

Caution: Federal law (USA) restricts this device to sale by or on the order of a physician. Please refer to the instructions for use supplied with the product for detailed instructions, warnings, and cautions.

Smiths Medical design mark, Portex and acapella are registered trademarks of the Smiths Medical family of companies. The symbol ® indicates the trademark is registered in the U.S. Patent and Trademark Office and certain other countries.

©2007 Smiths Medical family of companies. All rights reserved. RE434 5.2007

smiths medical